

## XIAMEN STARFLO INDUSTRY AND TRADE CO.LTD

Add:Room 811,JinZhu Creative Industry Park ,No 13 Zhongwan Road,Jimen Strict,Xiamen,China

Contact Person : Julia      Email: [Julia@starflopump.com](mailto:Julia@starflopump.com)

### FLO SERIES DIAPHRAGM PUMP, SPRAYER PUMP



Reciprocating Diaphragm made of thermoplastic :Santoprene

Duty cycle : working intermittent.

Housing: PA66

Check valve made : EPDM/VITON

Check valve spring Stainless steel

Port size:9.5mm(3/8") Hose barb

Self-priming so pump can be located above supply tank

Flow rate:1.13GPM(4.3L/Min.)Nominal @ open flow

Liquid temperate:60 centigrade degree

Model	Volt	Flow(L/Min)	Pressure(PSI)	Amp Draw(A)
FLO-2201	12	2	55	1.8
FLO-2202	12	3.8	35	3
FLO-2202-1	12	4.3	35	3.5
FLO-2203	12	2.6	70	2.1
FLO-2203-1	12	3.1	70	2.2
FLO-2202A	12	4	80	2.6
FLO-2401	24	2	55	0.9
FLO-2402	24	3.8	35	1.5
FLO-2403	24	2.6	70	1
FLO-2402A	24	4	80	1.3
Inlets size:	3/8"hose barb, thread			
Outlets size:	3/8"hose barb, thread			
dimension/pc:	18.5x11x6.5cm			
Net weight/pc:	0.64kg			
Gross weight/pc:	0.72kg			
Carton dimension(50pcs):	56.5x38.5x36.5cm			

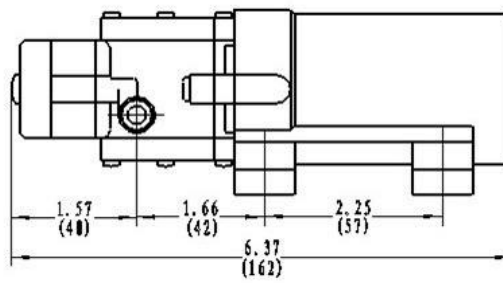
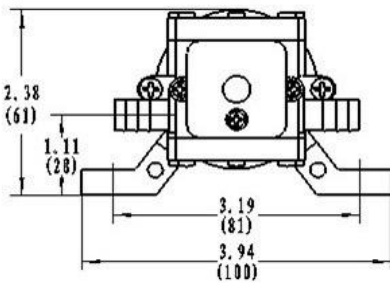

## FL SERIES HIGH FLOW



Reciprocating Diaphragm made of thermoplastic :Santoprene  
 Duty cycle : working intermittent.  
 Housing:casted Iron  
 Check valve made : EPDM/VITON  
 Check valve spring Stainless steel  
 Port size:(12.5mm)1/2" Hose barb,3/4" NPT thread  
 Built -in thermal protector at 120°C  
 Self-priming so pump can be located above supply tank  
 Liquid temperate: 60°C  
 Motor voltage:12V,24V DC,115V,220V AC

Model	Volt	Flow(L/Min)	Pressure(PSI)	Amp Draw(A)
FL-30	12	10	17	2.2
FL-31	24	10	17	1.5
FL-35	12	12.5	35	7
FL-34	24	12.5	35	4
FL-40	12	17	40	9.2
FL-44	24	17	40	5.6

### TECHNICAL DATA OF AC VOLTAGE

Model	Volt	Flow(L/Min)	Pressure(PSI)	Amp Draw(A)
FL-33	115	12.5	35	0.5
FL-32	220	12.5	35	0.4
FL-41	115	17	40	0.5
FL-43	220	17	40	0.8

Inlets size:	1/2" Hose barb with filter
Outlets size:	1/2" Hose barb,3/4" NPT thread
dimension/pc FL-3:	33.5x12.5x10.5cm
Net weight/pc FL-3:	1.9kg
Gross weight/pc FL-3:	2.4kg
Carton dimension(10pcs FL-3 Series):	63x29x22.5cm
dimension/pc FL-4:	37x12.5x10.5cm
Net weight/pc Shape FL-4:	2.5kg
Gross weight/pc FL-4:	2.9kg
Carton dimension(10pcs FL-4 Series):	64x39x22cm



- 1.Stainless steel bolts
- 2.Water resistant pressure switch
- 3.Snap-in connection
- 4.Special valve and diaphragm for easy priming
- 5.Moisture resistant O ring seal motor
- 6.Double ball bearing motor for smooth, quiet operation
- 7.Rubber mounted for smooth and quiet operation
- 8.Sealed drive bearings, corrosion resistant

## DP SERIES PUMP-HIGH PRESSURE



Duty cycle : working intermittent.  
 Housing:casted Iron  
 Check valve made : EPDM/Viton  
 Check valve spring Stainless steel  
 Port size:9.5mm(3/8") Hose barb, 1/2"NPT thread  
 Built -in thermal protector at 120°C  
 Self-priming so pump can be located above supply tank  
 Liquid temperate: 60°C  
 Motor voltage:12V,24V DC,115V,220V AC

Model	Volt	Flow(L/Min)	Pressure(PSI)	Amp Draw(A)
DP-60	12	4.6	60	7
DP-60B	24	4.5	60	4
DP-80	12	5.5	80	8
DP-100	12	5.5	100	9
DP-120	12	5.5	120	9.5
DP-120B	24	5.3	120	4.5
DP-160	12	5.5	160	10.5
DP-160B	24	5.5	160	4.2
DP-100M	230	5.5	100	0.6
DP-160S	120	5.5	160	1
DP-120M	220	5.5	120	0.5
DP-160M	220	5.5	160	0.55
Inlets size:	3/8"hose barb, 1/2"NPT thread			
Outlets size:	3/8"hose barb, 1/2"NPT thread			
dimension/pc:	26.5x12x10.5cm			
DC gross weight/pc:	2.7kg			
AC gross weight/pc:	3.3kg			
Carton dimension(10pcs AC Voltage):	64x39x22cm			
Carton dimension(10pcs DC Voltage):	63x29x22.5cm			

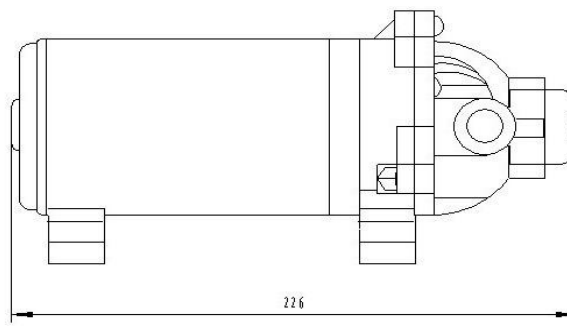
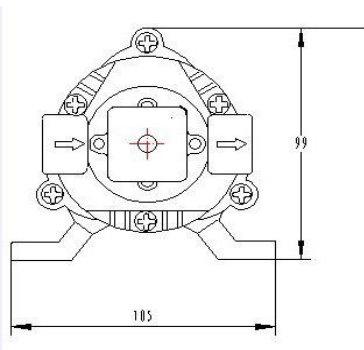

### FL-55 SERIES DIAPHRAGM PUMP



Reciprocating Diaphragm made of thermoplastic :Santoprene  
 Duty cycle : working intermittent.  
 Housing:casted Iron  
 Check valve made : EPDM  
 Check valve spring Stainless steel  
 Port size:(12.5mm)1/2" Hose barb,3/4" NPT thread  
 Built -in thermal protector at 120°C  
 Self-priming so pump can be located above supply tank  
 Liquid temperate: 60°C  
 Motor voltage:12V,24v (Other volatage consultant us)

Model	Volt	Flow(L/Min)	Pressure(PSI)	Amp Draw(A)
FL-55	12	20	55	16
FL-200	12	10	200	15
Inlets size:	1/2" Hose barb with filter			
Outlets size:	1/2" Hose barb,3/4" NPT thread			
dimension/pc FL-55:	240*135*138mm			
Net weight/pc FL-55:	3.4kg			
Gross weight/pc FL-55:	3.5kg			

### FL-30 SERIES SMALL PUMP HIGH PRESSURE



Reciprocating Diaphragm made of thermoplastic :Santoprene  
 Duty cycle : working intermittent.  
 Housing:stainless iron  
 Check valve made : EPDM  
 Check valve spring Stainless steel  
 Port size:9.5mm(3/8") Hose barb  
 Snap-in port \* 1/2" NPT thread elbow  
 Add pressure release valve & switch pressure  
 Self-priming so pump can be located above supply tank  
 Liquid temperate: 60°C  
 Motor voltage:12V,24V,36V,48V DC.

Model	Volt	Flow(L/Min)	Pressure(PSI)	Amp Draw(A)
FL-3202	12	5.1	80	4.5
FL-3402	24	5.1	80	2.8
FL-3203	12	5.1	100	5
FL-3403	24	5.1	100	3
FL-3206	12	6	65	6
Inlets size:	3/8"hose barb, thread			
Outlets size:	3/8"hose barb, thread			
Dimension/pc:	20x12x8cm			
Net weight/pc:	1.13kg			
Gross weight/pc:	1.22kg			
Carton dimension(30pcs):	55x40x28cm			

### SF33-45-12 SERIES WATER PUMP



Reciprocating Diaphragm made of thermoplastic :Santoprene  
 Duty cycle : working intermittent  
 Housing:casted Iron  
 Check valve made : EPDM  
 Check valve spring Stainless steel  
 Port size: 1/2" -14MNPT  
 Add pressure release valve & switch pressure  
 Self-priming so pump can be located above supply tank  
 Liquid temperate: 60°C  
 Diaphragm: Santoprene  
 Leads : 16AWG,13" (33cm) long with 2-pin connector /Leads

Model	Volt	Flow(L/Min)	Pressure(PSI)	Amp Draw(A)
SF33-45-12	12	11.6	45	8
SF33-45-24	24	11.6	45	4
Inlets size:	1/2" -14MNPT			
Outlets size:	1/2" -14MNPT			
dimension/pc :	26x14x12.5cm			
dimension/carton(8pcs per carton) :	53.5x31.5x28.5cm			
Net weight/pc :	1.9kg			
Gross weight/pc:	2.31kg			

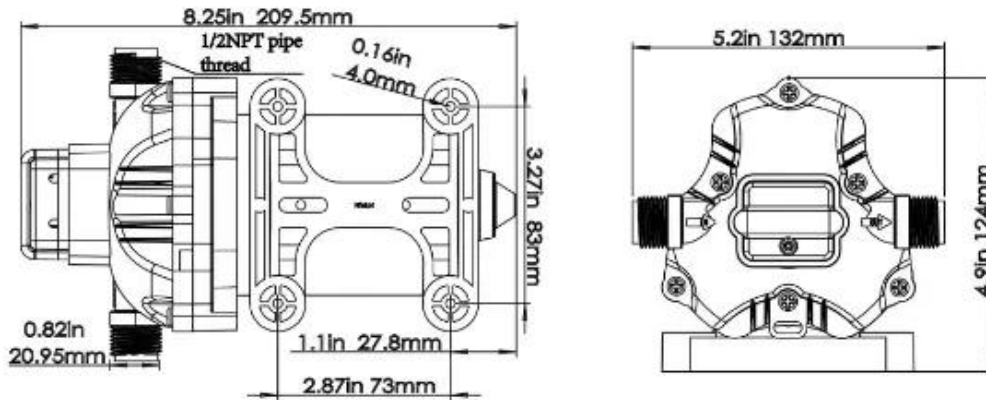

### SF42-55-12 SERIES WATER PUMP



Reciprocating Diaphragm made of thermoplastic :Santoprene  
 Duty cycle : working intermittent  
 Housing:casted Iron  
 Check valve made : EPDM  
 Check valve spring Stainless steel  
 Port size: 1/2" -14MNPT  
 Add pressure release valve & switch pressure  
 Self-priming so pump can be located above supply tank  
 Liquid temperate: 60°C  
 Diaphragm: Santoprene  
 Leads: 16AWG,13" (33cm) long with 2-pin connector /Leads

Model	Volt	Flow(L/Min)	Pressure(PSI)	Amp Draw(A)
SF42-55-12	12	11.3	55	7.5
SF42-55-24	24	11.3	55	4
Inlets size:	1/2" -14MNPT			
Outlets size:	1/2" -14MNPT			

dimension/pc :	26x14x12.5cm
dimension/carton(8pcs per carton) :	53.5x31.5x28.5cm
Net weight/pc :	1.9kg
Gross weight/pc:	2.31kg

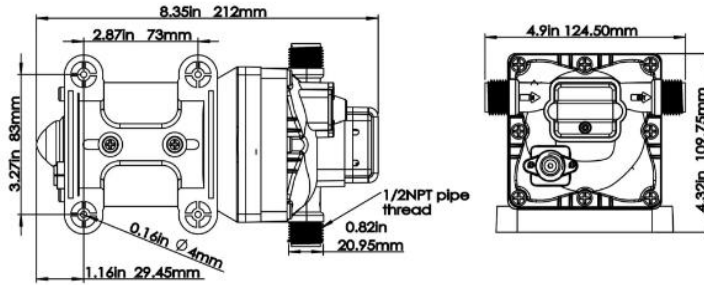

## 12V FAUCET / TAP & PUMP KIT Technical Data

### Description

Economical 12 volt galley pump system supplied complete with chrome plated 12 volt electric faucet & pump - so pump can be automatically activated by the toggle switch on the faucet. The pump is 'SELF-PRIMING' so it can be mounted virtually anywhere in your Boat/Caravan/RV etc... up to 1.5m above the water supply. Delivers up to 4.3 litres per minute at 5 metre head. Suits 10mm hose.

### DC Pumps details:

#### TECHNICAL DATA

- ◇ Model: FLO-2202
- ◇ Volts: 12
- ◇ Flow (L/Min): 4.3
- ◇ Pressure (PSI): 35
- ◇ Amp Draw (A): 3.5

#### SPECIAL FUNCTIONS

- Durable rubber feet for reduced vibration
- Quiet Performance with long life
- Runs dry without damage
- Self Priming
- Built-in Check Valve
- Easy Installation

### Electric Faucet details

- ◇ Full 360 degree rotation
- Suits 10mm ID hose
- Chrome mirror finish
- Marine pump set complete with mounting screws & faucet.
- Compact 12v electric pump operates quietly and easy to install
- Zinc-alloy metal faucet base and stainless steel swing spout
- Built-in 12v toggle switch in on the faucet base-To automatically activate pump
- Built in 15amp max on/off switch

### ELECTRIC

- ◇ 2 Chamber Diaphragm
- ◇ (3/8") 10mm Hose barb
- ◇ Liquid: 60°C Max
- ◇ Self-priming: Vertical within 1.5M
- ◇ Pressure PSI: 35 PSI
- ◇ Run Dry: Yes
- ◇ Leads: 16 AWG Red + Black
- ◇ Protection: Thermal Overload, Automatic Restart
- ◇ Motor: 12V Permanent Magnet, Intermittent Duty



### Pump Dimension

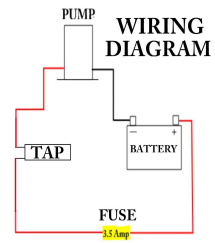
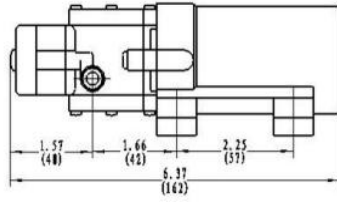
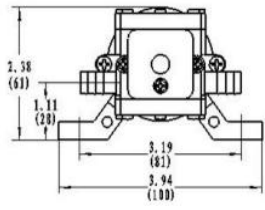



## Washdown Pump Kit Technical Data



Self priming 12 volt deck washdown pump delivering up to 20 litres per minute and pressure of up to 70psi. Incorporates a self contained shut off switch, so by connecting the outlet hose to a garden hose fitted with the pistol grip nozzle supplied, you can have high pressure water on demand by activating the nozzle.

### Features:

- ✦ Complete washdown pump kit with spray nozzle and coiled hose
- ✦ Powerful 5-chamber positive displacement diaphragm pump, for smooth and quiet flow
- ✦ Self-priming 12V pump with automatic pressure switch control - automatically turns on and off as you turn nozzle on and off
- ✦ **18.9 Litres per minute** (5 GPM) capacity flow, and high 70 PSI pressure
- ✦ Professional grade pump - Ideal for cleaning boats, fish boxes, anchor wells, dinghies and caravans
- ✦ Multi-step corrosion protection and seamless motor body for enhanced protection
- ✦ Rubber mounting feet for corrosion protection and noise reduction
- ✦ Santoprene diaphragm - Can run dry without damage
- ✦ Thermal overload and ignition protection
- ✦ Easy connecting system
- ✦ Suits liquid with weak acid/alkaline, weed sprayers & salt water

### Technical Data:

Model	Volt	Flow rate	Max Pressure	Max Amps(A)	Package	N.W/G.W(kgs)
FL-35S	12Vdc	20LPM	70PSI	20.0A	30*26*25.5cm	3.9/4.35

### Full system Including:

- Full system Including
- \*1pc 12v pump
  - \*1pc Coli hose—Suits 12mm (1/2") diam. hose
  - \*1pc Quick connect adapter
  - \*1pc Inlet filter/strainer
  - \*1pc Trigger nozzle—Open pressure 55 PSI (3.8 bar)
  - \*1pc Instruction manual
  - \*2pcs Straight barbed fittings
  - \*2pcs Brass fittings



### PUMP SIZE:

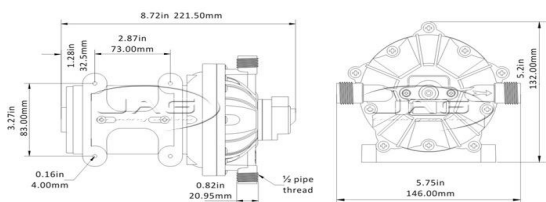

## Macerator Pump technical data

**STARFLO** Macerator pump is designed specifically for sanitation waste and fish box evacuations. This high-powered pump incorporates our high quality motor with a new seamless shell and splash proof design.

The Macerator features a premium impeller design and includes o-ring sealed end bells with a sealed manual turn key to withstand the harsh marine environment.

### Specification

- ✧ Pump Headm:2 chambers
- ✧ pen Flow:49.2L/min
- ✧ Inlet/ Outlet size:2"(50mm)/1"(25mm)
- ✧ Motor Configuration lead wires 2-pin connector
- ✧ 12GPM(45.00LPM)
- ✧ Self Priming
- ✧ Seamless Motor Shell
- ✧ O-Ring Shaft Seal
- ✧ Heavy Duty Shaft Seal
- ✧ Manual Turn Key With Rear O-Ring Seal
- ✧ Innovative Internal Housing Design
- ✧ Dual Blade Design
- ✧ Premium Impeller
- ✧ Ignition Protection
- ✧ Thermally Protected
- ✧ Available in 12, 24, 115 and 230 Volts



Model	Volts (dc)	Open Flow gpm(lpm)	Amps Max	Packing Size(mm)	N.W/G.W(kg)
FL-65A	12 Vdc	12.0(45.0)	9	320×135×110	2.10 / 2.40
FL-65B	24 Vdc	12.0(45.0)	6	320×135×110	2.10 / 2.40

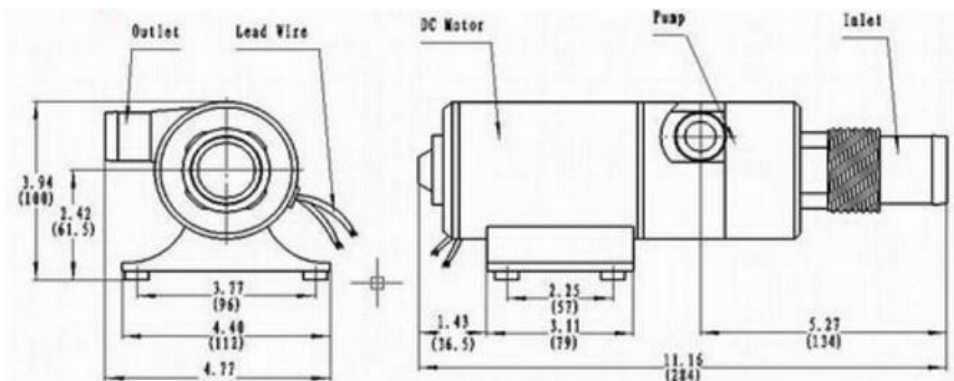

## Solar Submersible Pump for Deep Well Technical Data

### Features:

- ✦ Long-life 24VDC operation
- ✦ For 4" wells or larger
- ✦ Runs dry without damage
- ✦ 50 mesh stainless steel inlet screen
- ✦ State of the art solid diaphragm
- ✦ Quick disconnect with "Watertight-Gland" Design Pat Pend
- ✦ Corrosion-proof housing with stainless-steel fasteners

### Description:



Model	Volt(V)	Flow Rate (LPM)	Max.Lift (M)	Max. Submersible (M)	Amps (A)	N.W/G.W (kgs)
SF1240-30	12	6	70	30	8	2.9/3.0
SF2440-30	24	6	70	30	4	2.9/3.0

### THE WHOLE SOLAR WATER PUMP SYSTEM (SOLAR PUMP+CONTROLLER+SOLAR PANEL)

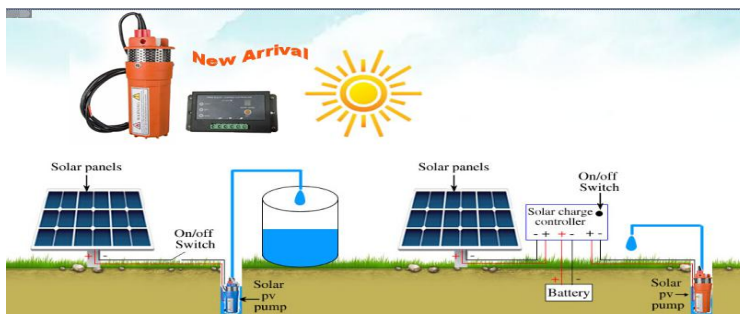

### New Design Solar Submersible Pump Technical Data

A high-efficiency positive-displacement diaphragm submersible solar water pump. The system is designed for off-grid households as a near zero recurring cost replacement for diesel. This pump max flow rate can be 720LPH(189GPH), the Max head can be 100M.

Its unique water-tight power connector stops water wicking and prevents potential condensation problems.

Great for livestock watering, irrigation, pond aeration, remote homes and cabins.

**Features:**

- Stainless steel submersible pump
- Built thermal protector
- Low power, high effect
- Small volume, widely used
- Large flow, high lift
- For 4" wells or larger
- Quick disconnect with "Watertight-Gland" Design Pat Pend
- Corrosion-proof housing with stainless-steel fastener
- Run dry without damage
- State of the art solid diaphragm
- Stainless Steel Pump case
- Pump Design: Positive Displacement 3 Chamber Diaphragm Pump
- Motor: Permanent Magnet Thermally Protected
- Wire Length: 3M



**Advantage**

- Submersible pump with 100 meter (328 feet) maximum pumping head
- 60% peak efficiency
- Suitable for sprinkler or drip irrigation systems
- Up to 720 liters per hour or 7,200 liters per day with recommended battery bank
- 24V DC motor compatible with most commercially-available solar panels, charge controllers and lead acid batteries

**TECHNICAL DATA**

- Pump Design Positive Displacement 3 Chamber Diaphragm Pump
- Motor Permanent Magnet, Thermally Protected
- Voltage 24V / 12V DC Nominal
- Amps: 9.2A Max./11.3A Max.
- Internal Bypass 105-110PSI Max.(7.2-7.5 BARS)
- Maximum Lift 328 Feet Maximum (100m)
- Maximum Submerion 100 Feet Maximum (30m)
- Outlet Port 1/2"(12.7mm) Barbed Fitting for 1/2" (12.7mm) I.D.Tubing
- Inlet 50 Mesh Stainless Steel screen
- Materials High Strength Engineered Plastics, Stainless Steel Fasteners
- Potable Water Well Pump

Model	Volt	Flow Rate	Lift(M)	Amps(A)	Body Cover
SF1280-30	12V	12LPM	100M	11.3A	Stainless Steel Body
SF2480-30	24V	12LPM	100M	9.2A	Stainless Steel Body

**High Flow Rate 5 Chamber Diaphragm Pumps Technical data  
Specially for Adblue liquid**

The HV series 5 chamber diaphragm pumps with the Permanent magnet motor and continuous duty cycle, self-priming ability can be more than 3 meters. The pumps can be applied for fresh water, weak acid&basicity liquid, and specially for Adblue liquid.

**Features:**

- ✦ Permanent magnet and continuous duty.
- ✦ Built-in pressure switch automatically starts and stops.
- ✦ Pump when faucets is opened.
- ✦ Self-priming 3m so pump can be located above water tank.
- ✦ Runs dry for extended periods of time without damage.
- ✦ Hold excellent motor keep stable temperature of pump body.

Items No	Voltage (v)	Open Flow rate (L/min)	Pressure PSI	Amps (A)	Speed (rpm)	N.W/G.W (kg)
HV-25A	12Vdc	20-25	60-80	10.0	2700	4/4.5
HV-25B	24Vdc	20-25	60-80	6.0	2700	4/4.5
HV-25M	230Vac	20-25	60-80	1.0	2700	4/4.5
HV-25S	115Vac	20-25	60-80	1.5	2900	4/4.5
HV-30A	12Vdc	30-35	40	15.0	2800	5/5.5
HV-30B	24Vdc	30-35	40	7.5	2800	5/5.5
HV-30S	115Vac	30-35	40	4.0	3400	6/6.5
HV-30M	230Vac	30-35	40	1.5	2900	6/6.5
HV-40S	115Vac	40	25	4.2	3400	6/6.5
HV-40M	230Vac	40	25	1.8	2900	6/6.5
HV-50S	115Vac	50	25	4.5	3400	6/6.5
HV-50M	230Vac	50	25	2.0	2900	6/6.5

**HV-25A**



**HV-25M**



**HV-30A**



**HV-40M  
HV-50M**



**AUS32/Adblue Sytem/Urea Solution**



Item No	Description	Images
Adblue automatic nozzles	Automatic Trigger nozzle with safety cut out valve Materials of construction stainless steel, viton Fitting:3/4" BSPP Flow range:0~60L/min Max.pressure:5 bar	
Adblue Manual Nozzles	Filling Nozzle manual Trigger Nozzle Fittings:19mm barb Flow range:0~80L/min Max.pressure:3.5Bar	
Adblue meter(K24)	Type:Inline turbine meter polyamide body Flow range:10~120L/min Accuracy:+-1% Pressure:10bar Connections:BSPT 1" or NPT1"	
Adblue EPDM hose	Size:19mm ID transfer hose supplied complete with 1"BSPT Type:EPDM Internal diameter:19mm Wall Thickness:4mm Flow range:0~60L/min	
Sec Suction Coupling	Type: Female coupling Fitting:3/4" BSPP Flow(max): 40L/min (0.6bar max.pressure drop) Pressure(max.2bar)	
Adblue pump	Volt: 12v 24v DC/115v 230v AC , Flow: 30L/m,40L/m,50L/min Self priming: More than 3 meters Port size: Hose tail connection 3/4" 1"	
Bracket Set Nozzle holder	Design specially for this system Bracket set material: Iron	

**BW SERIES BOTTLED WATER SYSTEM TECHNICAL DATA  
FOR HOME AND COMMERCIAL APPLIANCES**



Voltage: 115V & 230V AC; 12V DC

Cycle: 50/60 HZ, for AC models

Duty cycle :Working intermittent

Maximum Flow: 1.0 GPM(3.8L/min)

Maximum Pressure:40PSI(2.8bar)

Weight:6.4 Net Lbs.(2.9kg),Shipping 7.8 Lbs(3.5kg)

- ◆ Float switch for automatic shut-off when bottle is empty.
- ◆ Built-in check value to prevent back flow.
- ◆ Universal seal cap fits most water containers.
- ◆ Compact size for easy mounting.
- ◆ 20' discharge hose included.
- ◆ Easy installed.

Model	GPM	Max PSI	Out Let	Tubi ng	Volts	Amp s	Cycle	Cord	Dimensions(H x W x D)	Weight(kgs)
BW1000A	1.0	40	1/4"	20'	115V AC	0.5	50/60	6'	3.0" x 5.5" x 7.5"	3.5
BW2000A	1.0	40	1/4"	20'	220V AC	0.25	50/60	6'	3.0" x 5.5" x 7.5"	3.5
BW3000A	1.0	40	1/4"	20'	12V DC	5.0	50/60	6'	3.0" x 5.5" x 7.5"	3.5
BW4003A	1.0	40	1/4"	20'	115V- 240AC	0.5	50/60	6'	3.0" x 5.5" x 7.5"	2.8
BW2020A	1.0	40	1/4"	20'	115V /220V AC	0.55	50/60	6'	3.0" x 5.5" x 7.5"	4.0

**Application**



**Features and Benefits:**

- Long Life Motor: Ensures years of reliable operation
- Sailflo Diaphragm Pump: Provides dependable run dry capabilities, extending the life of the pump
- Quiet Operation: Equipped with noise dampening rubber feet to minimize noise pollution
- Built-in Check Valve

**Including:**

- Suction wand and hose assembly.
- Pump module with On/Off switch.
- 6 foot cord with plug.
- 20 feet of 1/4" discharge tube
- Universal seal cap: Fits any 3, 5, and 6 gallon plastic water bottle.
- Installation and maintenance instructions.

## Gear Oil Pump Technical Data

### Application:

Diesel, Lubricant, Viscous Liquids

Be able to use for water and machinery fuel except gasoline.

### BENEFITS

- Reversible self-priming
- Compact size with exceptional flow rate(3.7GPM/14.0LPM)
- Powerful reversible pumps specially designed to be used with oils

### Technical Specification

Ports: 3/8" Male JIC

Amps: 3.8A@12v - 2.0A@24v

Flow Rate: 3.7 GPM / 14.0 LPM

Self priming: 5 feet (wet gears)

Lift: 15 feet

Pump body: Brass

Gears: Bronze

Shaft: Stainless Steel

Seal: Fluoroelastomer lip seal

Motor: DC 12v or 24v



3/8" MNPT\*1/2 Barb

Model	Volt	Flow rate	Max Lift	Amps(A)	Max Draw(A)	Packing size(mm)	N.W/G.W(kgs)
SFGP-12	12Vdc	14LPM	3M	7A	10A	215*135*110	2.48/2.68
SFGP-24	24Vdc	14PLM	3M	4A	6A	215*135*110	2.45/2.68

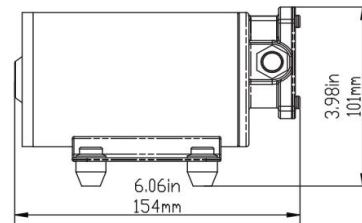
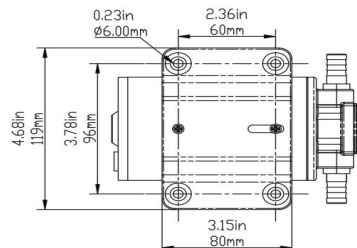
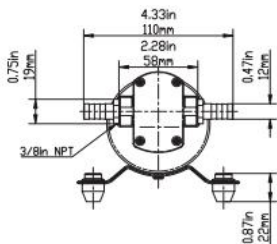



## Impeller Pumps Technical Data Engine cooling pump/ bilge pump/ Deck washdown pump

### Mainly Application:

Used in marine to drain water on deck and wash deck

### Features:

Good flow rate, continuously rated pump

8.5 gpm (32 lpm) at 10ft (3m) total head

Self-priming up to 4ft (1.2m) allows

Mounting above wet bilges

Shower debris presents no problem to this bronze bodied, flexible impeller design

Simple design means fewer wearing parts-all user serviceable

Complies with USCG 183.410 and ISO 8846

MARINE (ignition Protection)

ISO 8849 MARINE (Bilge Pump Standard)



### Remind

Should be installed in a dry and ventilated position

Must not run dry, it is better to work with a bilge control panel to avoid running dry

### Specifications:

Body Materials	Bronze
Impeller	NBR Rubber
Seal	Lip Type
Ports	3/4" Female Thread (FNPT)
Voltage	12V/24 DC
Motor	Permanent Magnet Type Fully Enclosed Stainless Steel, High quality seamless design
Self-Priming	3.0m vertical lift
Pressure	Can generate pressures up to 2 bar(30psi)

Model	Volt	Flow rate	Max Lift	Amps(A)	Max Draw(A)	Packing size(mm)	N.W/G.W(kgs)
SF-32-12	12Vdc	30LPM	3M	8.0A	10.0A	215*135*110	2.38/2.58
SF-32-24	24Vdc	30PLM	3M	5.0A	7.0A	215*135*110	2.35/2.58

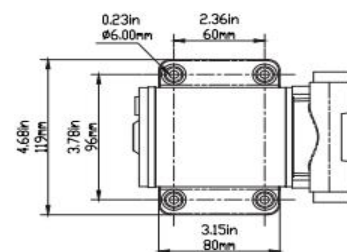
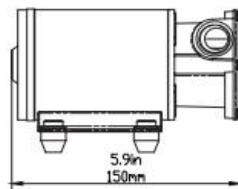
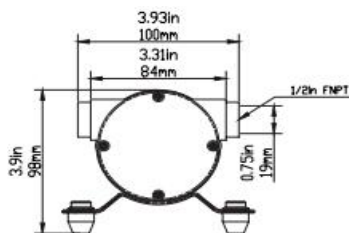

## 350GPH-550GPH BILGE PUMP TECHNICAL DATA



### Features & Benefits

Pump and switch are stand alone products  
 Compact, efficient, long life motors  
 New mercury free float switches

Volt: 12 and 24 volt versions  
 Easy clean snap-lock strainer bases

Anti-Airlock protection  
 Exclusive moisture tight seals  
 Completely submersible  
 Marine grade blocked wiring  
 Silent and vibrationless operation

### Typical Applications

Marine  
 RV & Campers  
 Industrial

### PUMP Liquid Temperature

110°F (43°C) Max.  
 Priming Capabilities  
 Not needed flooded suction  
 Power  
 3.0 amps max current draw  
 Max.Pressure  
 Not needed

### MOTOR

Type  
 Compact, efficient, long life motor

### Leads

18 AWG, 1 m long Leads

### Temperature Limits

110°F (43°C) Max.  
 Duty Cycle  
 Intermittent

Voltage  
 12v/24v

Model	Flow rate	Volts	Current	Head	Wire lead	Outlet Dia	N.W/G.W
SFBP350-12	350	12V	1.0A	3m	1 m	19 mm/3/4"	0.33/0.40 kg
SFBP500-12	500	12V	1.6A	3m	1 m	19 mm/3/4"	0.33/0.40 kg
SFBP500-24	500	24V	1.2A	3m	1 m	19 mm/3/4"	0.33/0.40 kg
SFBP750-12	750	12V	2.5A	3m	1 m	19 mm/3/4"	0.33/0.40 kg
SFBP750-24	750	24V	1.2A	3m	1 m	19 mm/3/4"	0.33/0.40 kg

## 1100 GPH BILGE PUMP TECHNICAL DATA



### Features & Benefits

Pump and switch are stand alone products  
 Compact, efficient, long life motors  
 New mercury free float switches

Volt: 12 and 24 volt versions  
 Easy clean snap-lock strainer bases

Anti-Airlock protection  
 Exclusive moisture tight seals

Completely submersible  
 Marine grade blocked wiring  
 Silent and vibrationless operation

### Typical Applications

Marine  
 RV & Campers  
 Industrial

### PUMP

#### Liquid Temperature

110°F (43°C) Max.

Priming Capabilities

Not needed flooded suction  
 Power  
 3.0 amps max current draw  
 Max.Pressure  
 Not needed

### MOTOR

Type  
 Compact, efficient, long life motor

Leads

18 AWG, 1 m long Leads

#### Temperature Limits

110°F (43°C) Max.

#### Duty Cycle

Intermittent

#### Voltage

12v/24v

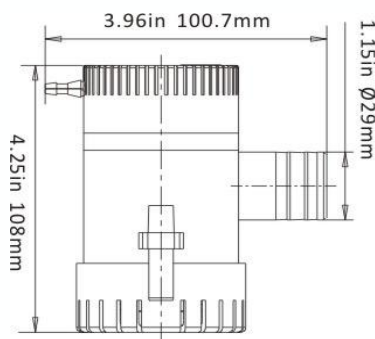

**1100 GPH**

Model	Flow rate	Volts	Current	Head	Wire lead	Outlet Dia	N.W/G.W
SFBP1100-12	1100 GPH	12V	3.0A	4m	1 m	29 mm/1-1/8"	0.38/0.44 kg
SFBP1100-24	1100 GPH	24V	1.8A	4m	1 m	29 mm/1-1/8"	0.38/0.44 kg

1500GPH & 2000GPH BILGE PUMP TECHNICAL DATA



**Features & Benefits**

Pump and switch are stand alone products  
 Compact, efficient, long life motors  
 New mercury free float switches  
 Volt: 12 and 24 volt versions  
 Easy clean snap-lock strainer bases

Anti-Airlock protection  
 Exclusive moisture tight seals  
 Completely submersible

Marine grade blocked wiring  
 Silent and vibrationless operation

**Typical Applications**

Marine  
 RV & Campers  
 Industrial

**PUMP**  
**Liquid Temperature**

110°F (43°C) Max.  
 Priming Capabilities  
 Not needed  
 flooded suction  
 Power  
 16.0 amps max current draw

Max. Pressure  
 Not needed

**MOTOR**

Type  
 Compact, efficient, long life motor  
 Leads

18 AWG, 1 m long Leads  
 Temperature Limits  
 110°F (43°C) Max.

Duty Cycle  
 Intermittent

Voltage  
 12v/24v

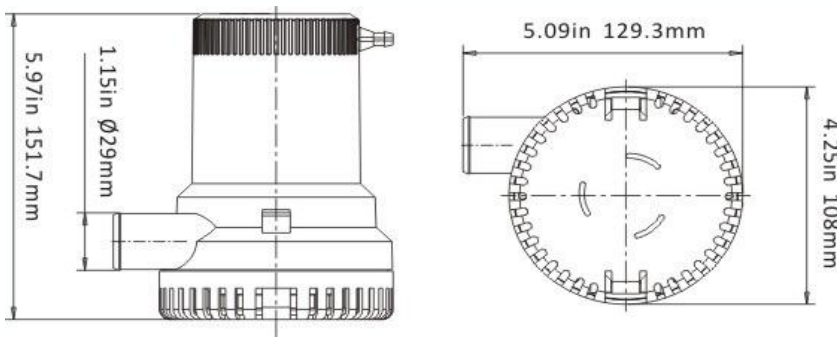

**2000 GPH**

Model	Flow rate	Volts	Current	Head	Wire lead	Outlet Dia	N.W/G.W
SFBP1500-12	1500 GPH	12V	8.0A	5m	1 m	29 mm/1-	1.13/1.21 kg
SFBP1500-24	1500 GPH	24V	4.0A	5m	1 m	29 mm/1-	1.13/1.21 kg
SFBP2000-12	2000 GPH	12V	8.5A	6m	1 m	29 mm/1-	1.13/1.21 kg
SFBP2000-24	2000 GPH	24V	5.0A	6m	1 m	29 mm/1-	1.13/1.21 kg

1500GPH & 2000GPH BILGE PUMP TECHNICAL DATA



**Features & Benefits**

Pump and switch are stand alone products  
 Compact, efficient, long life motors  
 New mercury free float switches

Volt: 12 and 24 volt versions  
 Easy clean snap-lock strainer bases

Anti-Airlock protection  
 Exclusive moisture tight seals  
 Completely submersible

Marine grade blocked wiring  
 Silent and vibrationless operation

**Typical Applications**

Marine  
 RV & Campers  
 Industrial

**PUMP**  
**Liquid Temperature**

110°F (43°C) Max.  
 Priming Capabilities  
 Not needed  
 flooded suction  
 Power  
 25.0 amps max current draw  
 Max.Pressure  
 Not needed

**MOTOR**

Type  
 Compact, efficient, long life motor

**Leads**

18 AWG, 1 m long Leads  
 Temperature Limits  
 110°F (43°C) Max.

Duty Cycle  
 Intermittent  
 Voltage  
 12v/24v

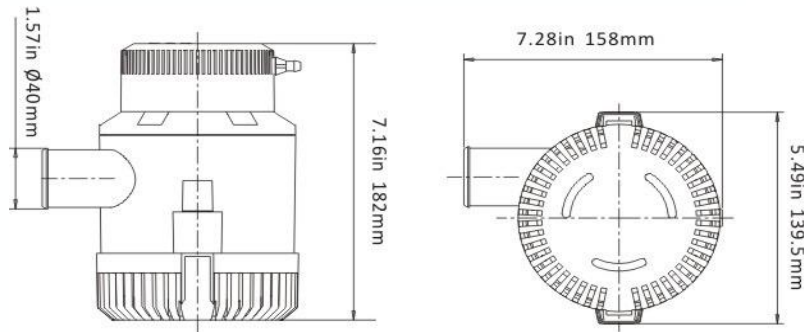

**3000 GPH**

Model	Flow rate	Volts	Current	Head	Wire lead	Outlet Dia	N.W/G.W
SFBP3000-12	3000 GPH	12V	14.0A	8m	1 m	40 mm/1-	2.10/2.37 kg
SFBP3000-24	3000 GPH	24V	7.0A	8m	1 m	40 mm/1-	2.10/2.37 kg
SFBP3500-12	3500 GPH	12V	16.0A	8m	1 m	40 mm/1-	2.10/2.37 kg
SFBP3500-24	3500 GPH	24V	8.0A	8m	1 m	40 mm/1-	2.10/2.37 kg
SFBP3700-12	3700 GPH	12V	16.0A	8m	1 m	40 mm/1-	2.10/2.37 kg
SFBP3700-24	3700 GPH	24V	10.0A	8m	1 m	40 mm/1-	2.10/2.37 kg

FLOAT SWITCH TECHNICAL DATA



**Features & Benefits**

- Turn pump on when water level reaches 2" (51mm)-SFBS-20-
- Turn pump off when water level reaches 3/4" (19mm)-SFBS-
- Ideal flow sensor for bilge pumps
- Heavy duty flow switch is designed for the toughest

**Typical Applications**

- Marine
- RV & Campers
- Industrial
- New mercury free float switch.
- Suitable for use with 12v DC or 24v DC

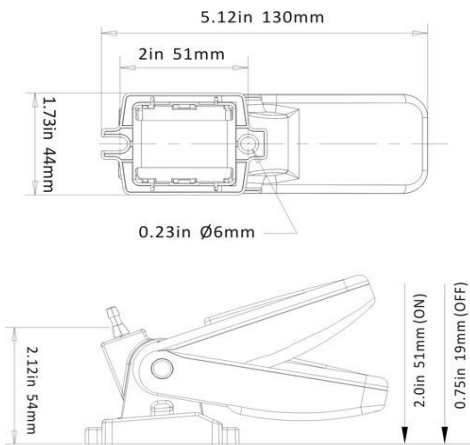

Model	SFBS-20-01
Max Amps 12volts	20A
Max Amps 24volts	10A
Wire Length	1M
Wire Gauge Size	18
N.W./G.W. (kg)	0.16/0.18

**AUTOMATIC BILGE PUMP 600GPH & 750GPH TECHNICAL DATA**



**Features & Benefits**

**All-in-one pump & switch-No float switch required** Pump turns on when water level rises & shuts off when water is removed  
Will not pump oil - straight motor oil that enters the bilge will not turn the pump on

Snap-off strainer for easy cleaning  
Anti-fouling impeller

Available in 600 & 750 GPH (2271 & 2838 LPH) models in 12 and 24 volt versions

**Typical Applications**

Marine  
RV & Campers  
Industrial

**PUMP**

**Liquid Temperature**

110°F (43°C) Max.

**Priming Capabilities**

Not needed flooded suction

**Power**

3.0 amps max current draw

**Max Pressure**

Not needed

**Outlet Ports**

3/4" (19 mm) Hose Barb

**Weight**

1.03 lbs (0.47 kg)

**Voltage**

12v/24v

**MOTOR**

**Type**

Compact, efficient, long life motor

**Leads**

18 AWG, 1 m long Leads

**Temperature Limits**

110°F (43°C) Max.

**Duty Cycle**

Intermittent

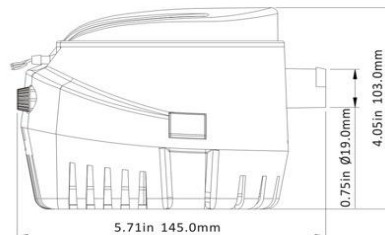
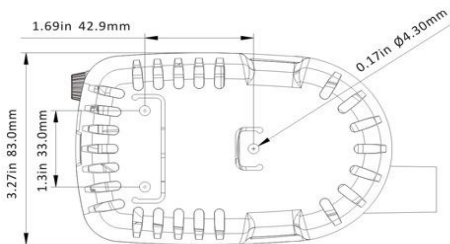

Model	Flow rate	Volts	Current	Head	Wire lead	Outlet Dia	N.W/G.W
SF-G600-12	600 GPH	12V	2.5A	2.5 m	1 m	19 mm/3/4"	0.47/0.52 kg
SF-G600-24	600 GPH	24V	1.5A	2.5 m	1 m	19 mm/3/4"	0.47/0.52 kg
SF-G750-12	750 GPH	12V	3.0A	3.0 m	1 m	19 mm/3/4"	0.47/0.52 kg
SF-G750-24	750 GPH	24V	1.6A	3.0 m	1 m	19 mm/3/4"	0.47/0.52 kg
SF-G1100-12	1100 GPH	12V	3.8A	5.0 m	1 m	29mm/1-1/8"	0.47/0.52 kg
SF-G1100-24	1100 GPH	24V	2.0A	5.0 m	1 m	29mm/1-1/8"	0.47/0.52 kg